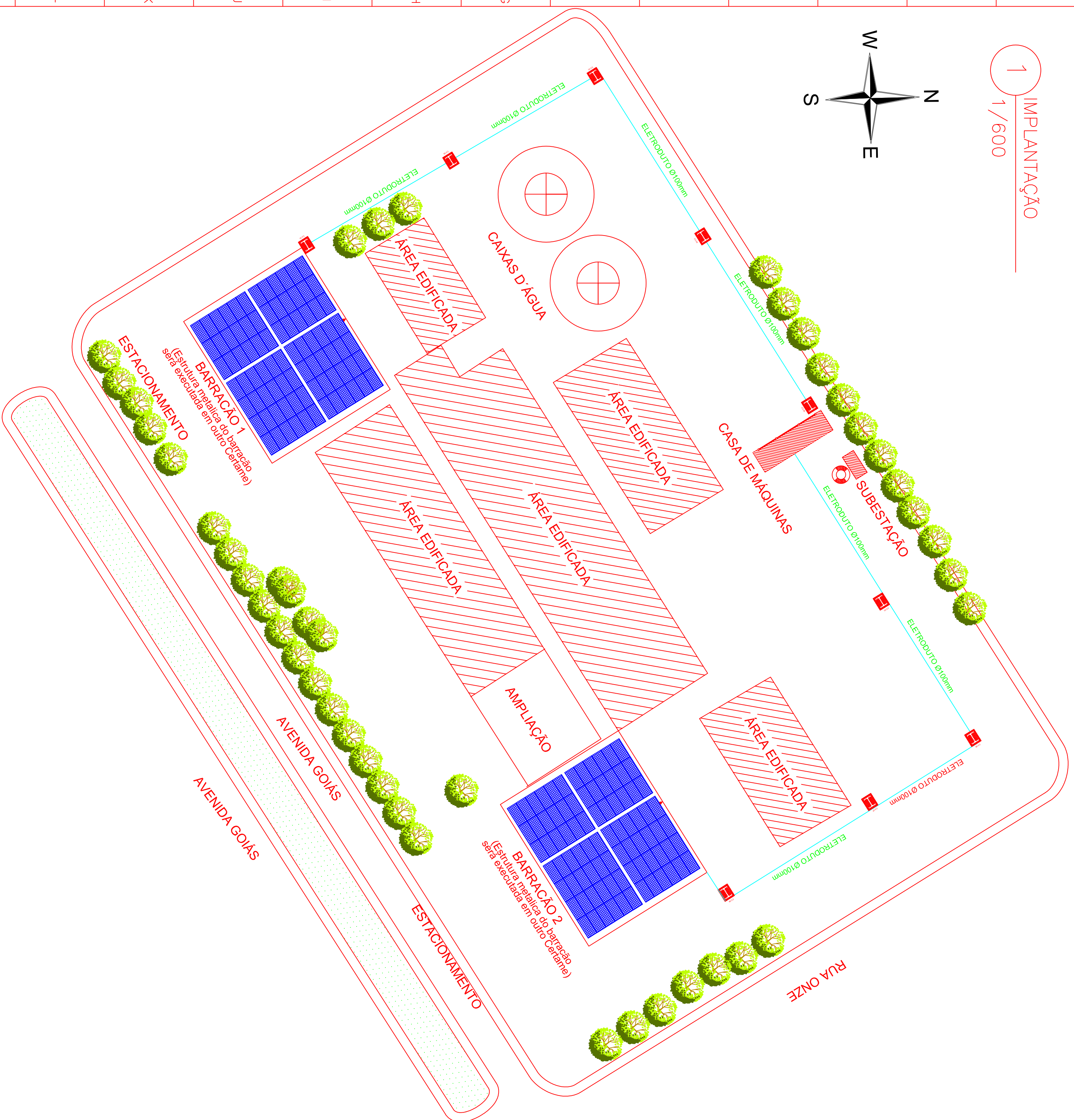
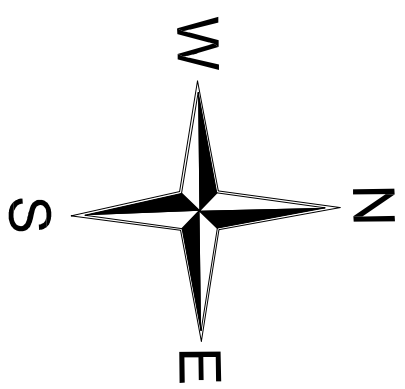

1 IMPLANTAÇÃO

 $\frac{1}{600}$ 

LAYOUT BARRACÃO

2 (Estrutura metálica do barracão será executada em outro Certeame)
1/270

1/270

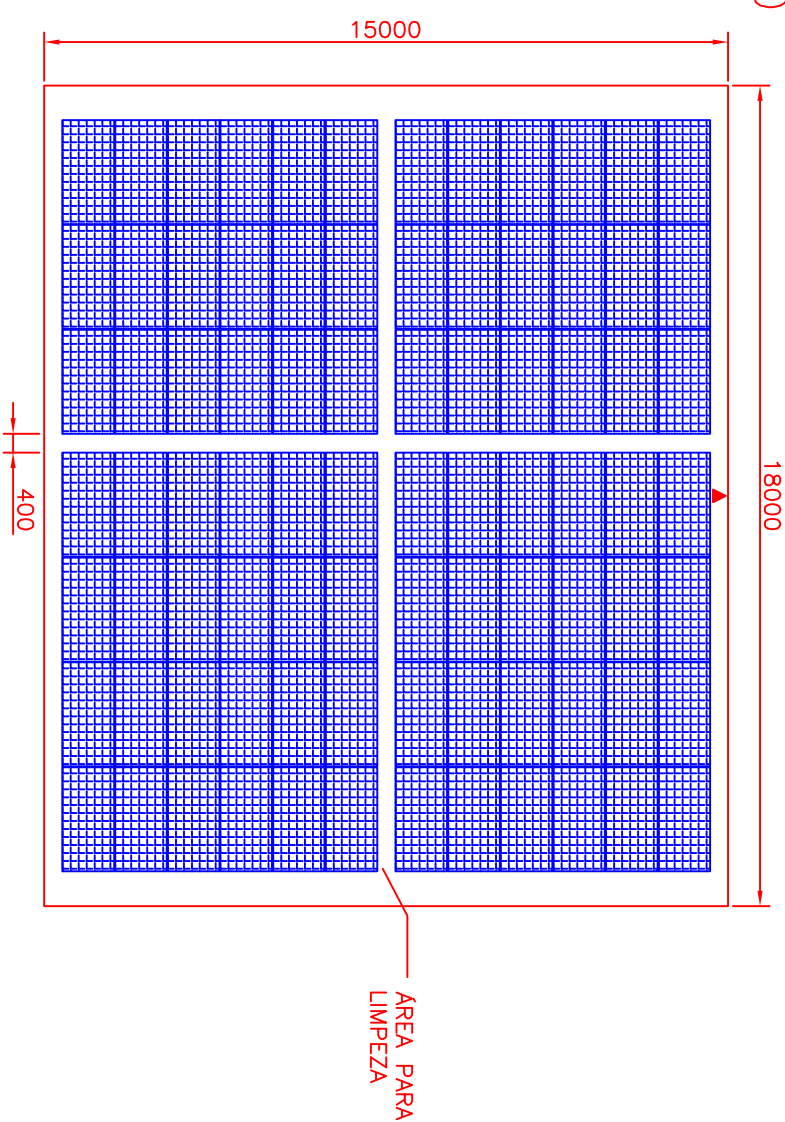

7 ESTRUTURA BARRAÇÃO

(Estrutura metálica do barracão
será executada em outro Certame)



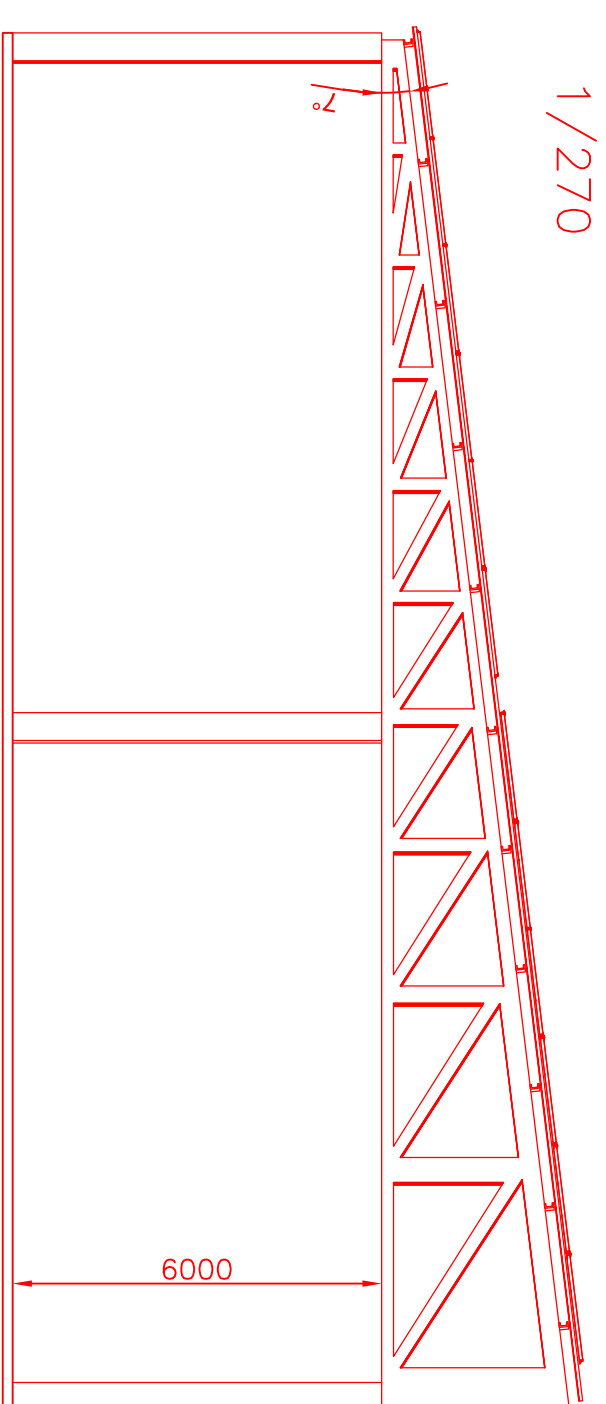

1/270

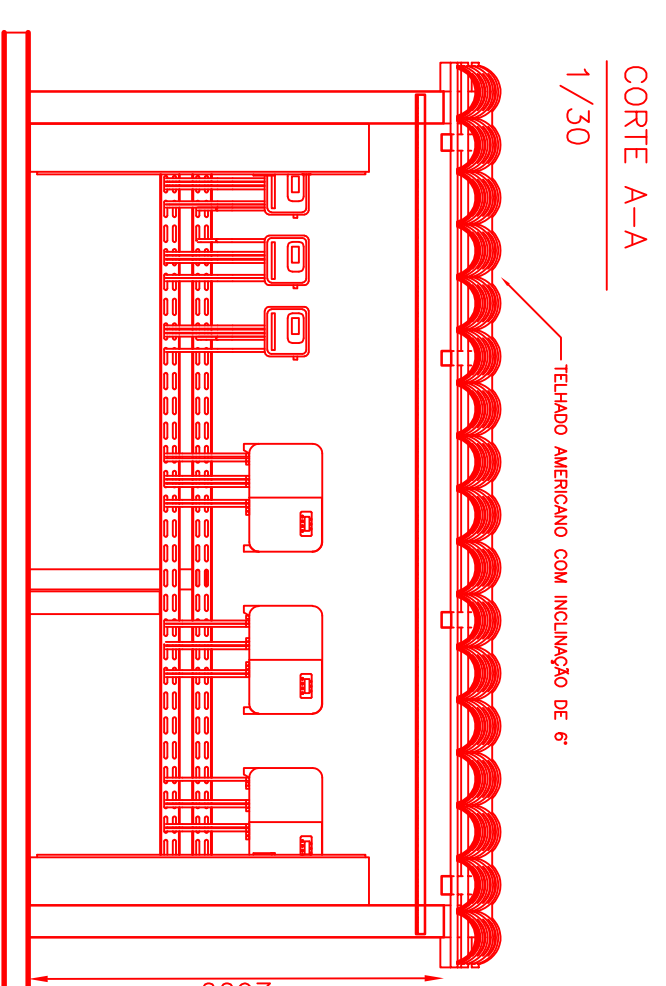
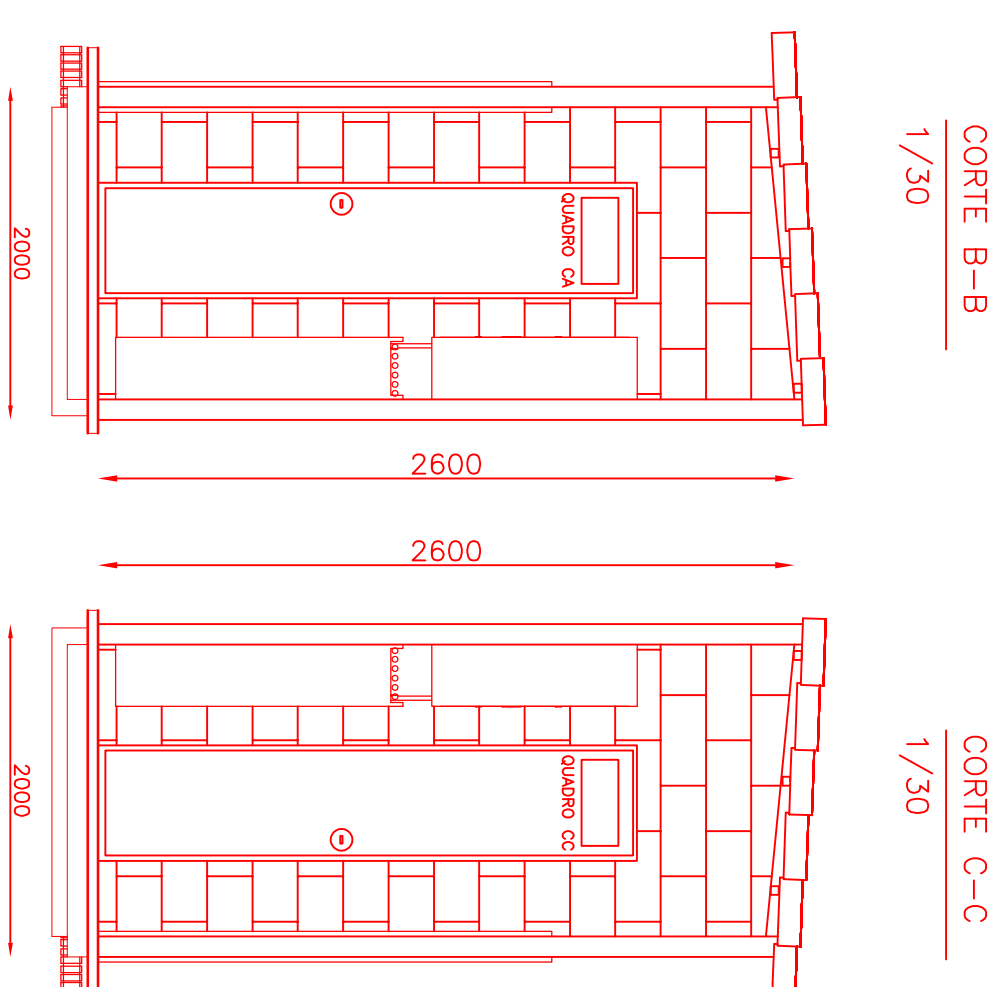
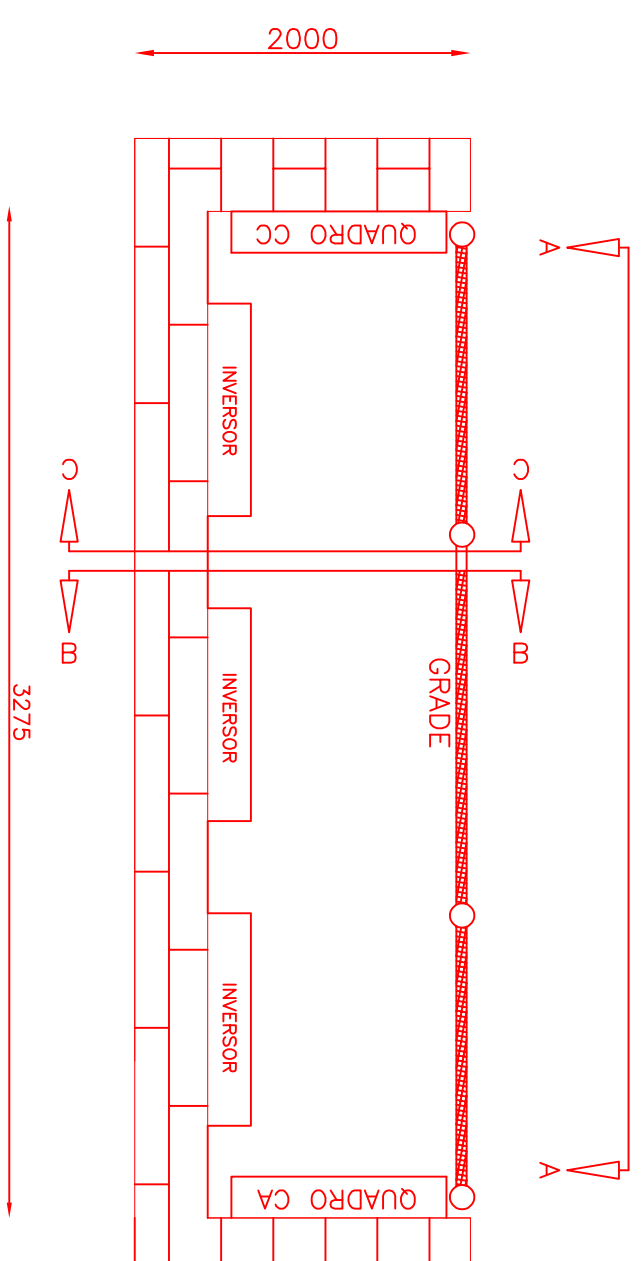
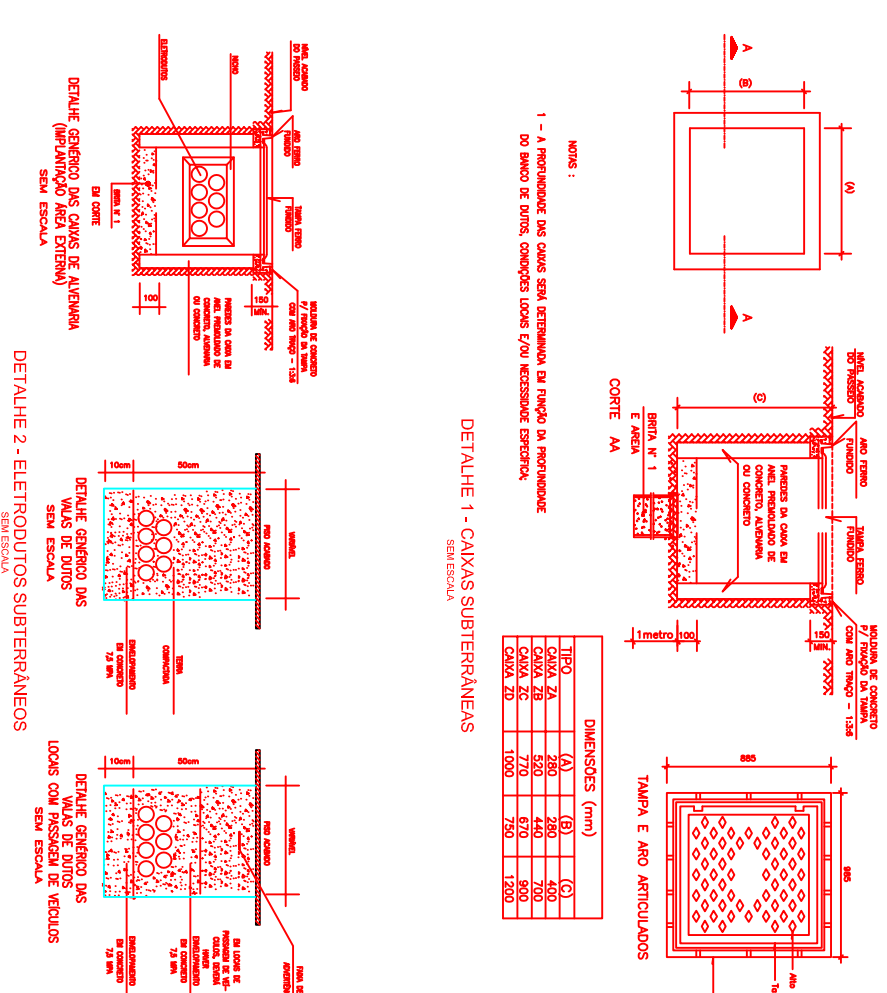

4 CASA DE MÁQUINAS

4) 1/20

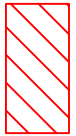

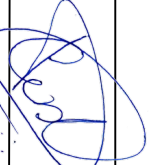
LEGENDA			
SIMBOLOGIA	DESCRIÇÃO	UNID.	
	PLACA FOTOVOLTAICA 550W 2,27X1,13M	168	
PESO KG	PESO UNITÁRIO MÓDULO 550W – 27.2 KG	4,56T	
	INDICA DIREÇÃO DE QUEDA DAS ÁGUAS	2	
	INDICA ÁREA EDIFICADA	–	
<div><div><p>Prefeitura Municipal INACIOLÂNDIA Alm. 2017, 2024 CONSTRUINDO UM NOVO TEMPO</p></div><div></div></div>			
Título/Conteúdo			
Nome do Empreendimento INSTALAÇÃO DE USINA FOTOVOLTAICA – HOSPITAL MUNICIPAL		Finalidade GERAÇÃO DE ENERGIA LIMPA	
Endereço Avenida Pomona, nº 24	Bairro Centro	Cidade: Inaciolândia-RO	
Proprietário			
MUNICÍPIO DE INACIOLÂNDIA			
Responsável Técnico  Engº LUCIANO DE CASTRO PEREIRA – CREA-RO 5575/D-1			
Folha			
02/02			